

Wipe

11055227

The RGE damper is used to manually balance and isolate a circular ducting system, while ensuring a very low leak rate.



PRODUCT BENEFITS

- class D airtight performance as per EN 1751.

Principles of operation

The flap of the RGE manual damper is opened and closed by rotating a handle located on a jumper. If it is closed, the airtight seal is formed by the moulded seal on the disc.

Product description

The sealed RGE manual damper balances airflow and isolates a circular ducting system. The manual RGE features a sealed disc to minimise air leaks between upstream and downstream of the damper in the closed position and double-lip airtight seals on each junction to minimise leaks with the rest of the system. Its top jumper enables overlaid insulation without covering the handle.

Fields of application

New, Refurbishment, Non-residential buildings

Installation

- installed in circular ducts.

Main characteristics

- galvanised steel,
- airtight performance upstream/downstream of disc: class 3 (160 mm and below) and 4 (200 mm and above), as per EN 1751,
- class D product airtight performance as per EN 12237,
- temperature range up to 120 °C.

General data

Variants	Main material
11055227	Galvanised steel

Dimensional data

Variants	H (mm)	L (mm)	Ø (mm)
11055227	45	198	355

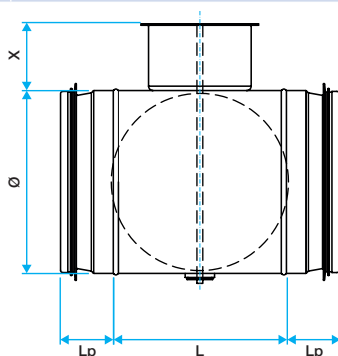

Regulatory data

Variants	Airtightness class	Upstream/downstream airtightness class
11055227	D	4

Wipe

11055227