

## 11055232

The RGE motorised damper uses a motor to balance and isolate a circular ducting system, while ensuring a very low leak rate.



## PRODUCT BENEFITS

- class D airtight performance as per EN 1751,
- easy installation of motor.

### Principles of operation

The flap of the Motorised RGE is opened and closed by a motor installed on the plate.

### Product description

The RGE damper balances airflow and isolates a circular ducting system. It features a sealed disc to minimise air leaks between upstream and downstream of the damper in the closed position and double-lip airtight seals on each junction to minimise leaks with the rest of the system. It can easily be motorised using its plate, which enables overlaid insulation without covering when in the upper position.

### Fields of application

New, Refurbishment, Non-residential buildings

### Installation

- installed in circular ducts.

### Main characteristics

- galvanised steel,
- airtight performance upstream/downstream of disc:
  - up to and including diameter 160 mm: class 3 as per EN 1751,
  - diameter 200 mm and above: class 4 as per EN 1751,
- class D product airtight performance as per EN 12237,
- motor plate included,
- motor: 2 N.m for RGE Ø 125 to 200 and 4-5 N.m beyond,
- temperature range: up to +120°C.

### Accessories

Description	Variants
LM MOTOR 24A ON/OFF	11055042
LM MOTOR 230A ON/OFF	11055051
LM MOTOR 230A SR PROPORTIONAL	11055052
LM MOTOR 24A SR PROPORTIONAL	11055053
NM MOTOR 230A SR PROPORTIONAL	11055055
MOTOR LF230 ON/OFF	11055081
LF MOTOR 24 ON/OFF	11055082

### General data

Variants	Main material
11055232	Galvanised steel

11055232

Dimensional data

Variants	H (mm)	L (mm)	Ø (mm)
11055232	55	198	400

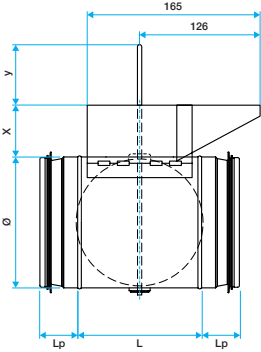

Regulatory data

Variants	Airtightness class	Upstream/downstream airtightness class
11055232	D	4