

CO2 sensor

11034080

EasyVEC® MICRO-WATT 12000 IP HMI CIRC STR

The best-designed range of exhaust box fans on the market, making ventilation efficient, serene, and easy.



## PRODUCT BENEFITS

- wide range from 4000 to 12,000 m<sup>3</sup>/h,
- up to 30% less electricity consumed in relation to a Standard unit,
- 100% recyclable.

## REGULATIONS AND COMPLIANCES

Technical Opinion no.: 14.5/16-2185\_V2

## Principles of operation

EasyVEC® Micro-watt delivers exhaust ventilation in non-residential buildings via air exhaust or supply to ensure sufficient air quality and to preserve the building structure.

## Product description

The Micro-watt constant pressure controller enables significant savings on heating costs compared to a non-regulated (Standard) fan unit. AldesConnect™ Pro can remotely monitor the fan unit for greater responsiveness in handling breakdowns and malfunctions.

## Fields of application

New, Refurbishment, Non-residential buildings

## Installation

- installation:
  - indoor or outdoor location,
  - outdoors: for roof installation, preferably positioned out of the wind to limit pressure losses at the outlet.
- For better acoustic and aeratic performances, we recommend that you:
  - install sound attenuators at the unit connections,
  - use the ALDES VIRTUO-FIX range of sealed accessories,
  - use MS PRO sealed flexible sleeves to muffle ductwork vibrations.

## Reference arguments

- Application:
  - centralised, low-consumption unidirectional air supply or exhaust box fan for commercial CMEV system,
  - new builds and refurbishment,
  - air supply /exhaust,
  - Micro-watt controller for pressure control,
  - attic / equipment rooms / flat roofs,
  - indoor / outdoor.
- Description:
  - EasyVEC® Micro-Watt low-consumption exhaust box fan,
  - easy to select: Selector PoWair and Conceptor Ventilation design software,
  - easy to configure via intuitive interface,
  - easy to service: link to documentation via QR code, single access panel, compatible with AldesConnect™ Pro supervision service (optional),
  - low power consumption.

## CO2 sensor

11034080

EasyVEC® MICRO-WATT 12000 IP HMI CIRC STR

## Main characteristics

- 2 control modes: constant pressure to minimise consumption or via external 0-10V probe,
- EC low-consumption motor (50/60Hz),
- backward curve impeller,
- unit made of galvanised steel Z275,
- simple and intuitive EasyVEC® remote control,
- proximity switch as standard,
- humidity-controlled or pre-configured T.Flow control mode
- compatible with all types of ductwork, even with junctions,
- central system: savings on maintenance,
- alarm relay available by wiring to the PCB,
- multiple options and accessories:
  - filter box,
  - ISO filter coarse 60%, ePM10 50%, ePM1 50-75%, ePM1 85%,
  - pressure switch,
  - ducted discharge,
  - 25 mm dual-wall acoustic insulation,
  - compatible with Modbus RS485,
  - AldesConnect® Pro.
- made in France.

## Supplementary characteristics

- compatible with Technical Approval for Modulated Ventilation - Presence-Agito-CO2-Hygro no. 14.5/16-2185\_V1,
- ErP 2018,
- ECS-eligible: BAT-TH-112, BAT-TH-125, BAT-EQ-123.

## Accessories

| Description                              | Variants |
|--|----------|
| Thermal-magnetic circuit breaker 20A-25A | 11057057 |
| Duct sensor +25/+90°C                    | 11090900 |
| Airflow control kit (20-300 Pa)          | 11090901 |
| Duct sensor -10/+35°C                    | 11090902 |
| Female rain hood + screen Ø 710 mm       | 11056410 |
| OCTA D710 sealed                         | 11094647 |
| MS PRO V2 D710                           | 11094663 |

## Filters

| Description                    | Variants |
|--------------------------------|----------|
| G4 filter EasyVEC® 10000/12000 | 11034411 |
| M5 filter EasyVEC® 10000/12000 | 11034414 |
| F7 filter EasyVEC® 10000/12000 | 11034425 |
| F9 filter EasyVEC® 10000/12000 | 11034428 |

## Associated services

Commissioning

## General data

| Variants | Type of motor |
|----------|---------------|
| 11034080 | EC            |

CO2 sensor

## 11034080

## EasyVEC® MICRO-WATT 12000 IP HMI CIRC STR

### Dimensional data

| Variants | E (mm) | F (mm) | H (mm) | L (mm) | M (mm) | P (mm) | T (mm) | Y (mm) | Z (mm) | Ø (mm) |
|----------|--------|--------|--------|--------|--------|--------|--------|--------|--------|--------|
| 11034080 | 575    | 1155   | 905    | 910    | 60     | 945    | 960    | 940    | 115    | 710    |

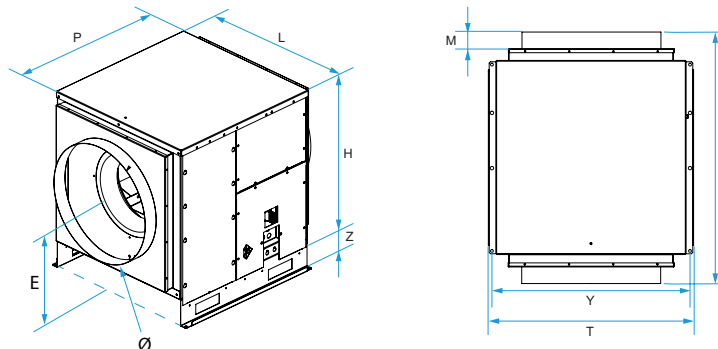

### Airflow data

| Variants | Airflow (m³/h) |
|----------|----------------|
| 11034080 | 12000          |

### Electrical datas

| Variants | Maximum power (W) | Max. power | Max. power | Protection rating | Maximum current (A) | Power supply |
|----------|-------------------|------------|------------|-------------------|---------------------|--------------|
| 11034080 | 3200              | 3,2        | 3200       | IP24              | 20,5                | Single-phase |

### Principles of operation

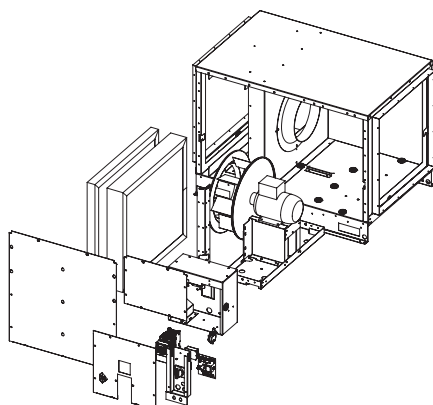

EasyVEC-MWPlus-12000

### Curve

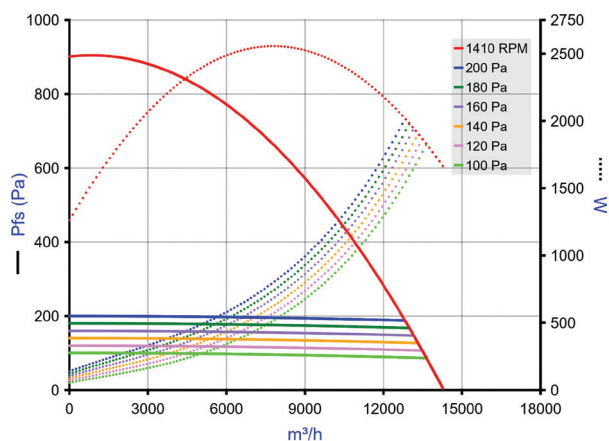

- > Aeraulic curves drawn up as per standard NF EN ISO 5801.
- > P (Pa) = static pressure.
- > P (W) = power consumption.