

## Fire damper

# 11043146

## ISONE®2.1 FTE70 RECT PM

ISONE® 2.1 dampers are simple to select: a single model for all partitions and all fire resistance levels.



ISONE2.1 Rectangular PM

### PRODUCT BENEFITS

- Single damper model for all partitions: easy to select
- Ergonomic quick reset handle: 2 seconds suffice.
- Optional stainless steel pin for harsh environments
- Optional remote control box, 0.7 m or 3 m cord
- ALDES SecurONE application for damper data collection and sharing
- Single mechanism, from the simplest to the highest-spec damper: easy to choose, install and maintain
- Easy to fit for damper installation in lightweight partition

- The damper is open in standby position.
- It opens when instructed by the FACP or thermal rod and moves into safety position (closed).
- Being motorised, it can be reset remotely.

### Product description

Fire dampers for non-residential buildings (public access building, high-rise)

They restore the fire resistance of partition walls crossed by a ventilation duct.

Equipped with 70°C fusible link trip device by default

Controllable by electromagnetic coil trip device: 24/48 V DC current emission; 24 V DC or 48 V DC current break

Reset motor 24/48 V AC/DC

Fire resistance up to 120 minutes on all common partition walls

ISONE® 2.1 Rectangular PM:

- (LxH): from 200x100 to 800x600 mm,

- ISONE® 2.1 control mechanism.

• ISONE® 2.1 GM Rectangular:

- (LxH): L•800, H•600, up to 1500x500 / 1000x1000.

### Fields of application

New, Refurbishment, Non-residential buildings

### Installation

- Mounted on lightweight partition with no seal, even with post-fitted frame,
- Embedded installation on:
  - Concrete and aerated concrete wall/slab
  - Plaster block wall
  - Type A plasterboards (1h) and type F (2h)
- Remote mounting on PROMAT / GEOSTAF using the EASYNSTALL kits,
- Easy to mount on lightweight partitions thanks to the installation brackets,
- Easynstall kit for simple mounting of rectangular dampers in type A lightweight partition (60 minutes),
- Adapter part for connection to oblong ducting,
- EXAP EN 15882-2:2015, rules X.45 and X.46: extended opening dimensions,
- Comply with fire resistance classification reports during installation.

### Main characteristics

- Certified and compliant with NF S 61937-5 and NF 537
- CE marked as per EN 15650: 1812-CPR-1837
- Class C airtight properties as per EN 1751 as standard
- EI 120 S - 500 Pa on concrete / aerated concrete walls and slabs, type F plasterboard, remote installation on PROMAT / Geostaf
- EXAP EN 15882-2:2015, rules X.45 and X.46.
- Range from 200x100 mm to 1500x500 mm / 1000x1000 mm

### REGLEMENTATIONS AND COMPLIANCES

PV CE number : 1812-CPR-1837

## Fire damper

# 11043146

## ISONE®2.1 FTE70 RECT PM

## Supplementary characteristics

- Fully upgradable mechanism
- Single damper adaptable to all walls
- Lightweight wall installation with post-fitted frame
- Reset handle indicating damper position
- Wide electrical connection box
- Optional stainless steel pin for harsh environments
- Easynstall kit for simple installation in lightweight partition
- Optional remote control unit
- Low pressure loss

## Accessories

Désignations	References
ISONE®2.1 Easynstall kit Rectangular PM	11043189
OBLONG RING ISONE®2.1 360x80/400x200	11043196
OBLONG RING ISONE®2.1 350x100/400x200	11043197
OBLONG RING ISONE®2.1 425x130/450x200	11043199
OBLONG RING ISONE®2.1 325x130/350x200	11043198
OBLONG RING ISONE®2.1 410x165/450x200	11043217
OBLONG RING ISONE®2.1 545x165/600x200	11043218
OBLONG RING ISONE®2.1 515x215/550x250	11043219
OBLONG RING ISONE®2.1 675x215/700x250	11043257
OBLONG RING ISONE®2.1 645x265/700x300	11043259
Remote box 0.7 m for FDCU1 limit switch and current make coil ISONE®2.1 PM small	11043324
Remote box 3 m for FDCU1 limit switch and current make coil ISONE®2.1 PM small	11043325
Adapter lead kit control pack ISONE®2.1 PM small	11043339
Remote box 0.7 m for FDCU1+2 limit switches and current make coil ISONE®2.1 PM small	11043396
Remote box 3 m for FDCU1+2 limit switches and current make coil ISONE®2.1 PM small	11043397

## General data

References	Free air passage section (dm <sup>2</sup> )
11043146	0,9 (Min) - 43 (Max)

## Dimensional data

References	E (mm)	F (mm)	G (mm)	ZA (mm)	Lmin x Hmin (mm)	Lmax x Hmax (mm)
11043146	25	169	71	Y/2 -122	200 x 100	800 x 600

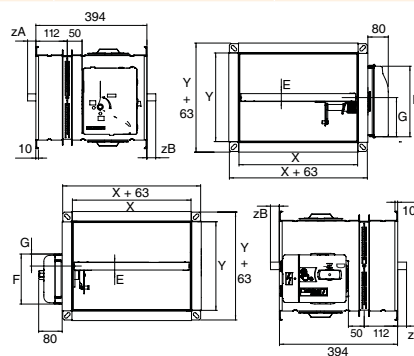

Encombrement ISONE®2.1 Rectangulaire

- ISONE® 2.1 GM: • 800x600 to 1500x500 / 1000<sup>2</sup>
- ISONE 2.1 PM: 200x100 to 800x600

Fire damper

11043146  
ISONE®2.1 FTE70 RECT PM

Airflow data

References	Pressure loss at 2 m/s (Pa)	Pressure loss at 4 m/s (Pa)	Pressure loss at 6 m/s (Pa)	Pressure loss at 8 m/s (Pa)	Pressure loss at 10 m/s (Pa)	Pressure loss at 12 m/s (Pa)
11043146	0	0	0	0	0	0

Installation visual 1

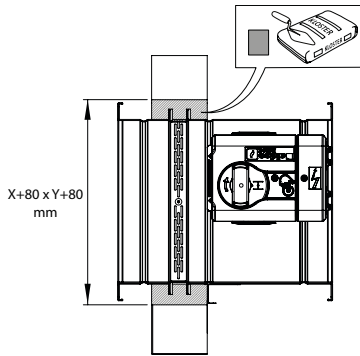

ISONE@2.1 rectangulaire sur mur béton

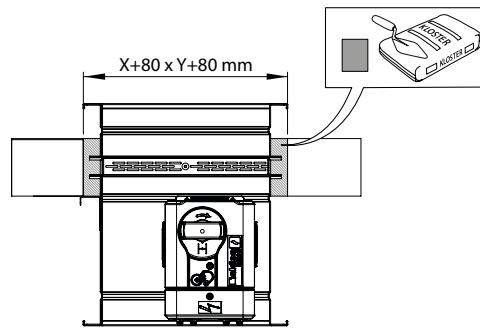

ISONE@2.1 rectangulaire sur dalle béton

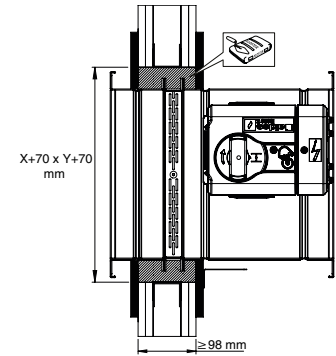

ISONE@2.1 rectangulaire sur cloison légère 120 minutes

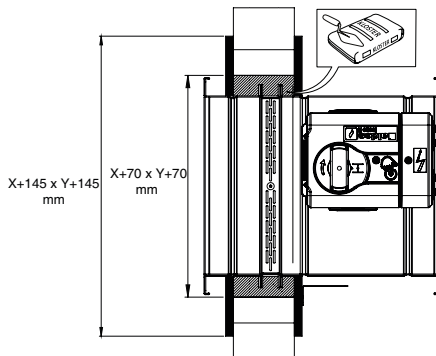

ISONE@2.1 rectangulaire sur cloison carreaux de plâtre 120 minutes

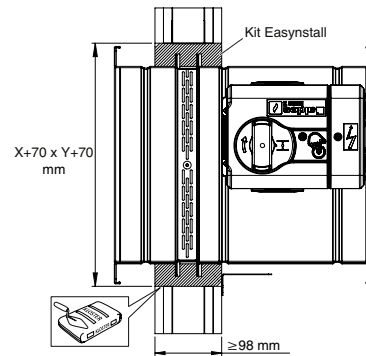

ISONE@2.1 rectangulaire sur cloison légère 60 minutes avec kit Easyinstall

Principe de fonctionnement



- > 1: installation bracket
- > 2: manufacturer's plate
- > 3: ISONE@2.1 PM mechanism
- > 4: blade thickness 25 mm (PM model) or 50 mm (GM model)
- > 5: 30 mm connection flange