

## Centralised vacuum system

11016258  
MR MONO D125 70m<sup>3</sup>/h

The MR Mono is an airflow regulator which ensures a stable airflow to control IAQ, comfort and energy savings in a room.



## PRODUCT BENEFITS

- ready for installation: no adjustments required,
- easy and rapid to install: multiple positions (horizontal vertical, any angle),
- low noise level.

## Principles of operation

Using its membrane, the MR Mono maintains a constant airflow in the air supply circuit or extract circuit, whatever the pressure variation over its operating range.

## Product description

The MR Mono is an airflow regulator which guarantees a stable airflow whatever the pressure variation, to prevent over-consumption due to excess airflow, ensure good IAQ and a high level of comfort. its membrane technology ensures low noise levels.

## Fields of application

Multi-occupancy residential housing, Individual residential housing, New, Refurbishment, Non-residential buildings

## Installation

- installed directly in the duct,
- installation direction indicated on component,
- horizontal or vertical installation at any angle,
- reserve distance with a grille, T-piece or bend: 1D on extract and 3D on air supply.

## Reference arguments

- The MR Mono D125 is the ideal solution to maintain a stable airflow at 70 m<sup>3</sup>/h whatever the pressure variation and across a wide pressure range
- Low noise level
- Extraction or supply
- Installed in vertical or horizontal duct at any orientation
- Plastic body (M1 fire rating) housing the silicone control membrane
- Support and air tightness provided by peripheral double-lip elastomer seal
- Operating temperatures: -10°C to +60°C
- Spacing required: 1xØ for extraction and 3xØ for supply
- Made in France

## Main characteristics

- plastic body (M1 fire protection rating),
- silicone control membrane,
- support and airtight properties using double-lip elastomer seal,
- operating pressure:
  - 50-200 Pa up to Ø125
  - 50-250 Pa beyond Ø150,
- tolerance in airflow over operating range:
  - Q average = Q nominal +/- 5 m<sup>3</sup>/h for MR ≤ 50 m<sup>3</sup>/h,
  - Q average = Q nominal +/- 10 % for MR Mono • 50 m<sup>3</sup>/h (except MR Mono Ø80, Ø100 and Ø125: +/-15% Q nominal)
- operating temperatures: -10°C to +60°C

## General data

| Variants | Airflow accuracy |
|----------|------------------|
| 11016258 | +/- 15%          |

Centralised vacuum system

**11016258**  
MR MONO D125 70m³/h

### Dimensional data

| Variants | A (mm) | E (mm) | F (mm) | Ø B (mm) | Ø N (mm) | Rated Ø duct (mm) | Weight (kg) |
|----------|--------|--------|--------|----------|----------|-------------------|-------------|
| 11016258 | 61     | 14     | 4      | 132      | 116      | 125               | 0,14        |

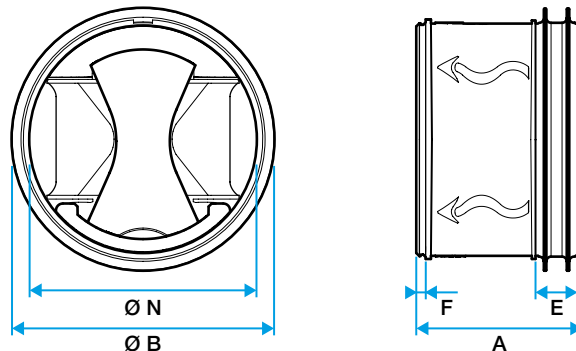

### Airflow data

| Variants | Airflow (m³/h) | Pressure range (Pa) |
|----------|----------------|---------------------|
| 11016258 | 70             | 50-200              |

### Regulatory data

| Variants | Fire protection rating |
|----------|------------------------|
| 11016258 | M1                     |

### Installation

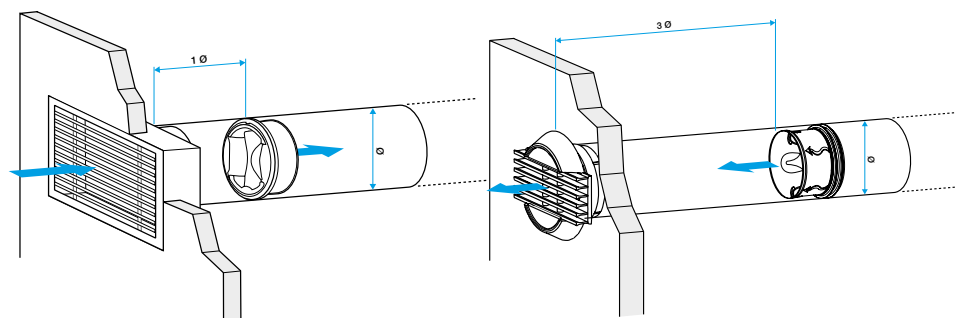

MR à l'extraction

MR au soufflage

Installation 360°