

Centralised vacuum system

11016078

MR Mono HP Ø 150 - 310 m3/h

The MR Mono is an airflow regulator which ensures a stable high-pressure airflow to control IAQ, comfort and energy savings in a room.



PRODUCT BENEFITS

- ideal for high pressure ducting: controls up to 650 Pa.
- low noise level,
- easy and fast to install: multiple positions (horizontal, vertical, any angle).

Principles of operation

Using its membrane, the MR Mono High Pressure maintains a constant airflow in the air supply circuit or return circuit, over a range of high pressures, whatever the pressure variation within this range.

Product description

The MR Mono High Pressure is an airflow regulator which guarantees a stable airflow over a range of high pressures, to prevent over-consumption due to excess airflow, ensure good IAQ and a high level of comfort. its membrane technology ensures low noise levels.

Fields of application

New, Refurbishment, Non-residential buildings

Installation

- installed directly in the duct,
- installation direction indicated on component,
- horizontal or vertical installation at any angle,
- reserve distance with a grille, T-piece or bend: 1D on extract and 3D on air supply.

Main characteristics

- plastic body (M1 fire protection rating),
- silicone control membrane,
- support and airtight properties using double-lip elastomer seal,
- operating pressure: 150-650 Pa,
- tolerance in airflow over operating range: +/- 10 %,
- operating temperatures: -10°C to +60°C

Accessories

| Description | Variants |
|------------------------|----------|
| Window sleeve Ø 150 mm | 11013123 |

General data

| Variants | Airflow accuracy |
|----------|------------------|
| 11016078 | +/- 10% |

Centralised vacuum system

11016078

MR Mono HP Ø 150 - 310 m³/h

Dimensional data

| Variants | A (mm) | E (mm) | F (mm) | Ø B (mm) | Ø N (mm) | Rated Ø duct (mm) | Weight (kg) |
|----------|--------|--------|--------|----------|----------|-------------------|-------------|
| 11016078 | 103 | 14 | 4 | 153 | 147 | 150 | 0,3 |

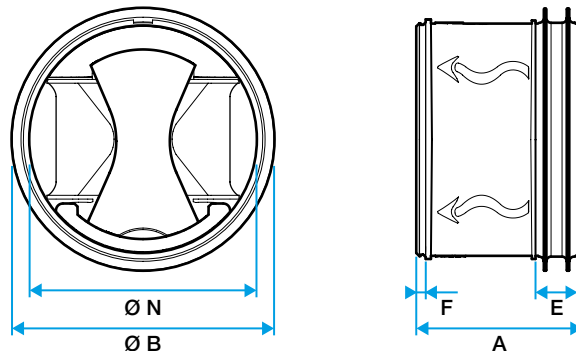

Airflow data

| Variants | Airflow (m ³ /h) | Pressure range (Pa) |
|----------|-----------------------------|---------------------|
| 11016078 | 310 | 150-650 |

Regulatory data

| Variants | Fire protection rating |
|----------|------------------------|
| 11016078 | M1 |

Installation

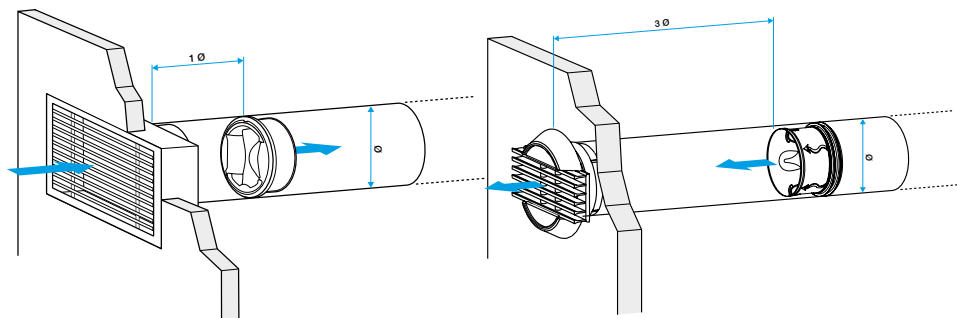

MR à l'extraction

MR au soufflage

Installation 360°