

## Centralised vacuum system

11016293

MR Mono Ø 200 - 225 m<sup>3</sup>/h

The MR Mono is an airflow regulator which ensures a stable airflow to control IAQ, comfort and energy savings in a room.



## PRODUCT BENEFITS

- ready for installation: no adjustments required,
- easy and rapid to install: multiple positions (horizontal vertical, any angle),
- low noise level.

## Principles of operation

Using its membrane, the MR Mono maintains a constant airflow in the air supply circuit or extract circuit, whatever the pressure variation over its operating range.

## Product description

The MR Mono is an airflow regulator which guarantees a stable airflow whatever the pressure variation, to prevent over-consumption due to excess airflow, ensure good IAQ and a high level of comfort. its membrane technology ensures low noise levels.

## Fields of application

Multi-occupancy residential housing, Individual residential housing, New, Refurbishment, Non-residential buildings

## Installation

- installed directly in the duct,
- installation direction indicated on component,
- horizontal or vertical installation at any angle,
- reserve distance with a grille, T-piece or bend: 1D on extract and 3D on air supply.

## Main characteristics

- plastic body (M1 fire protection rating),
- silicone control membrane,
- support and airtight properties using double-lip elastomer seal,
- operating pressure:
  - 50-200 Pa up to Ø125
  - 50-250 Pa beyond Ø150,
- tolerance in airflow over operating range:
  - Q average = Q nominal +/- 5 m<sup>3</sup>/h for MR ≤ 50 m<sup>3</sup>/h,
  - Q average = Q nominal +/- 10 % for MR Mono • 50 m<sup>3</sup>/h (except MR Mono Ø80, Ø100 and Ø125: +/-15% Q nominal)
- operating temperatures: -10°C to +60°C

## Accessories

Description	Variants
Window sleeve Ø 200 mm	11013125

## General data

Variants	Airflow accuracy
11016293	+/- 10%

Centralised vacuum system

## 11016293

MR Mono Ø 200 - 225 m<sup>3</sup>/h

### Dimensional data

Variants	A (mm)	E (mm)	F (mm)	Ø B (mm)	Ø N (mm)	Rated Ø duct (mm)	Weight (kg)
11016293	130	20	7	210	190	200	0,6

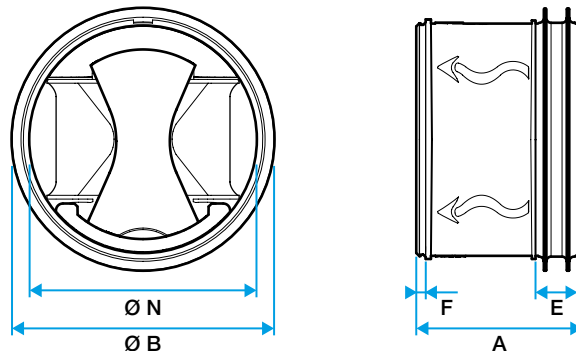

### Airflow data

Variants	Airflow (m <sup>3</sup> /h)	Pressure range (Pa)
11016293	225	50-250

### Regulatory data

Variants	Fire protection rating
11016293	M1

### Installation

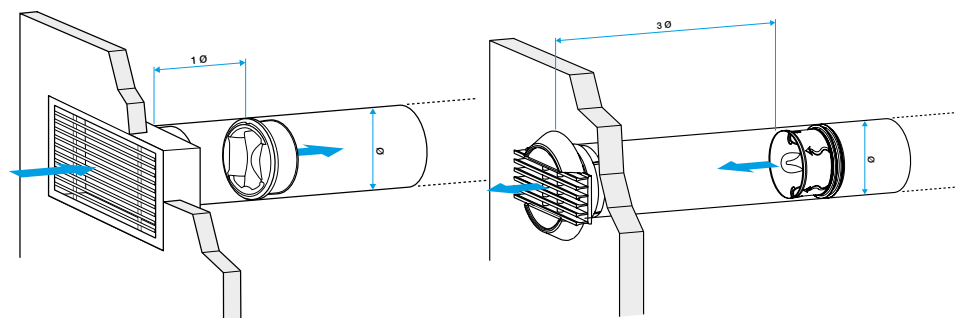

MR à l'extraction

MR au soufflage

Installation 360°