

## Centralised vacuum system

11016234  
MR Mono Ø 80 - 60 m<sup>3</sup>/h

The MR Mono is an airflow regulator which ensures a stable airflow to control IAQ, comfort and energy savings in a room.



## PRODUCT BENEFITS

- ready for installation: no adjustments required,
- easy and rapid to install: multiple positions (horizontal vertical, any angle),
- low noise level.

## Principles of operation

Using its membrane, the MR Mono maintains a constant airflow in the air supply circuit or extract circuit, whatever the pressure variation over its operating range.

## Product description

The MR Mono is an airflow regulator which guarantees a stable airflow whatever the pressure variation, to prevent over-consumption due to excess airflow, ensure good IAQ and a high level of comfort. its membrane technology ensures low noise levels.

## Fields of application

Multi-occupancy residential housing, Individual residential housing, New, Refurbishment, Non-residential buildings

## Installation

- installed directly in the duct,
- installation direction indicated on component,
- horizontal or vertical installation at any angle,
- reserve distance with a grille, T-piece or bend: 1D on extract and 3D on air supply.

## Main characteristics

- plastic body (M1 fire protection rating),
- silicone control membrane,
- support and airtight properties using double-lip elastomer seal,
- operating pressure:
  - 50-200 Pa up to Ø125
  - 50-250 Pa beyond Ø150,
- tolerance in airflow over operating range:
  - Q average = Q nominal +/- 5 m<sup>3</sup>/h for MR ≤ 50 m<sup>3</sup>/h,
  - Q average = Q nominal +/- 10 % for MR Mono • 50 m<sup>3</sup>/h (except MR Mono Ø80, Ø100 and Ø125: +/-15% Q nominal)
- operating temperatures: -10°C to +60°C

## General data

| Variants | Airflow accuracy |
|----------|------------------|
| 11016234 | +/- 15%          |

Centralised vacuum system

## 11016234

MR Mono Ø 80 - 60 m<sup>3</sup>/h

### Dimensional data

| Variants | A (mm) | E (mm) | F (mm) | Ø B (mm) | Ø N (mm) | Rated Ø duct (mm) | Weight (kg) |
|----------|--------|--------|--------|----------|----------|-------------------|-------------|
| 11016234 | 61     | 14     | 3      | 85       | 76       | 80                | 0,06        |

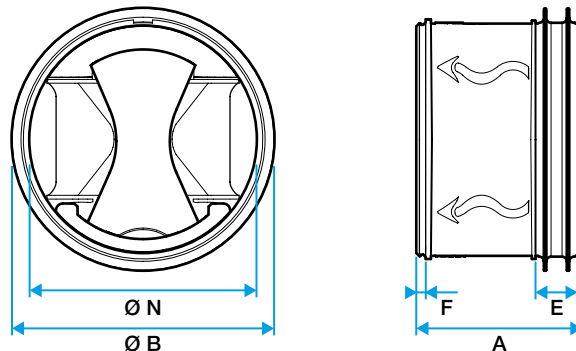

### Airflow data

| Variants | Airflow (m <sup>3</sup> /h) | Pressure range (Pa) |
|----------|-----------------------------|---------------------|
| 11016234 | 60                          | 50-250              |

### Regulatory data

| Variants | Fire protection rating |
|----------|------------------------|
| 11016234 | M1                     |

### Installation

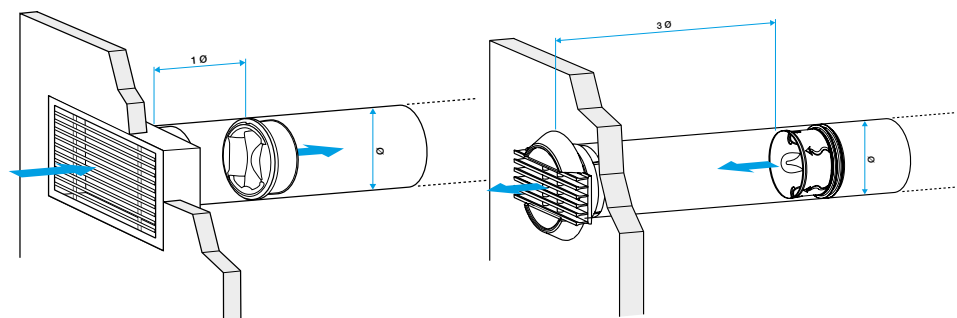

MR à l'extraction

MR au soufflage

Installation 360°