

Heat and smoke exhaust box fan accessory

11091097

Pressure switch kit 20-300 Pa ProtectONE® R

Product description

The pressure switch kit is suited to ProtectONE® R smoke and heat exhaust box fans. It can be adjusted over a pressure range from 20 to 300 Pa.

Fields of application

New, Refurbishment, Non-residential buildings

Installation

- install 1 pressure switch for each smoke and heat exhaust speed,
- pressure switch kit installed inside ProtectONE® R fan unit to protect against impacts and weather.

Main characteristics

- aeraulic connection,
- adjustable.

Installation

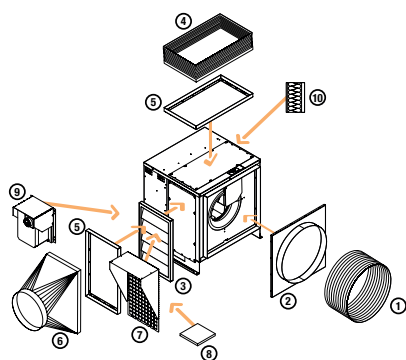

Options and accessories for ProtectONE® R (90° model)

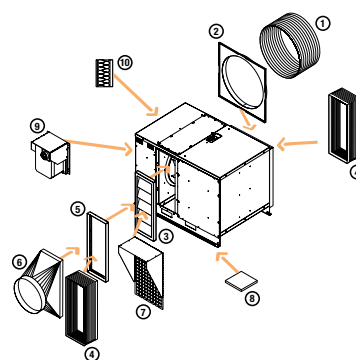

ProtectONE® R EL