

# 11039502

## ProtectONE® TA 250 1SP

ProtectONE® TA 1SP is an F400-120 1-speed smoke and heat exhaust box fan for commercial and industrial premises.



Smoke exhaust unit ProtectONE T

### PRODUCT BENEFITS

- easy airflow adjustment with the exclusive ProtectONE® Adapt device,
- can be fully dismantled as standard,
- thermal insulation for installation in equipment rooms.

### REGLEMENTATIONS AND COMPLIANCES

PV CE number : 1812-CPR-1548

### Principles of operation

When commanded by the FACP, the safety box will activate ProtectONE® T in smoke exhaust mode to extract smoke. The box will then switch to “default” mode, then “standby”.

### Product description

ProtectONE® TA 1SP is an F400-120 1-speed smoke and heat exhaust box fan for commercial and industrial premises. It features a belt-driven forward curve impeller. The ProtectONE® Adapt adjustment device can adjust the exhaust airflow easily at any time.

### Fields of application

New, Refurbishment, Non-residential buildings

### Installation

- indoors or outdoors,
- indoor installation: use thermal-acoustic insulation option (EN 12101-3),
- outdoor installation: use rain hood + bird screen,
- proximity switch supplied fitted and wired, with position contacts.

### Main characteristics

- complies with CE marking 1812-CPR-1548,
- certified EFECTIS F400-120 as per EN12101-3,
- safety box compliant with NF standards (NF S61-937-1, NFS61937-9, NF 537),
- belt-driven exhaust box fan,
- 9 models for airflow from 1,000 to 40,000 m<sup>3</sup>/h,
- single-speed motor generating 1.1 kW to 22 kW,
- balanced forward curve impeller,
- adjustable pulley,
- class F electric motor, IP55,
- galvanised steel casing, can be dismantled as standard,
- motor access panel adjustable on site,
- proximity switch fitted in factory,
- built-in airflow adjustment device: ProtectONE® Adapt (patented system) optional,

# 11039502

## ProtectONE® TA 250 1SP

### Supplementary characteristics

- accessories:
  - square/circular adjustment plate for intake,
  - rain hood anti-bird visor on outlet,
  - rectangular and circular flexible sleeve,
  - rectangular/circular flexible adapter part on outlet,
  - anti-vibration mountings,
  - backdraft damper,
  - rain hood + grille,
  - outlet flange,
  - AXONE 1SP safety box, 1-speed progressive start,
  - AXONE 2SP safety box, 2-speed smoke exhaust and comfort + smoke exhaust.
- available options:
  - "All-in-One" solution: safety box + switch + pressure switch installed and wired in factory,
  - choice of motor access panel,
  - horizontal or vertical outlet,
  - thermal + acoustic insulation certified 12101-3 for installation in equipment rooms,
  - variable pulley,
  - ProtectONE® Adapt (patented): rapid airflow adjustment.

### Accessories

Désignations	References
ProtectONE® T vertical outlet grille 250	11039622
Flexible connector - Ø 400	11096938
Pack of 4 anti-vibration mountings ProtectONE® T	11039347
RECT DIS SLV 250 PROTECTONE T	11039562
REC.CIR ADA INT D400 250 PROTE	11039572
RAIN HOOD GRILLE 250 PROTECTONE T	11039582
DISCHARGE FLANGE 250 PROTECT T	11039592
FLEXIBLE ADAPTER DISCHARGE 250 PROTECTONE T	11039602
NON-RETURN 250 PROTECTONE T	11039612

### Options

base
1.5/2P
1V<13KW
1V<23KW
1V<9KW
2.2/2P
3/4P
BRIDE2
ISOLB
PPTATR
PRESSD
PVAR5
VOLET2

### General data

References	Type of motor	Type of impeller
11039502	AC	Forward curve

# 11039502

## ProtectONE® TA 250 1SP

### Dimensional data

References	A (mm)	A.R (mm)	B (mm)	B.R (mm)	C (mm)	D (mm)	E (mm)	F (mm)	G (mm)	H (mm)
11039502	1152	400	792	43	791	619	319	145	600	324

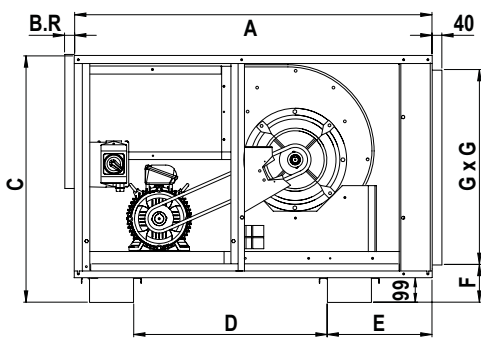

Encombrement (mm) - vue de profil

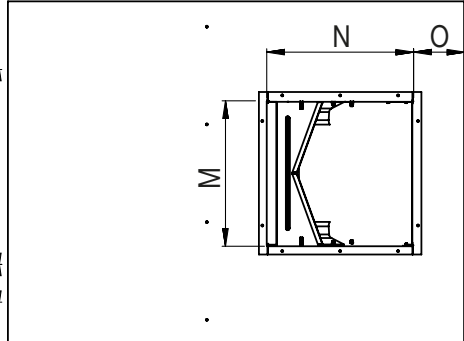

Encombrement (mm) - vue de dessus

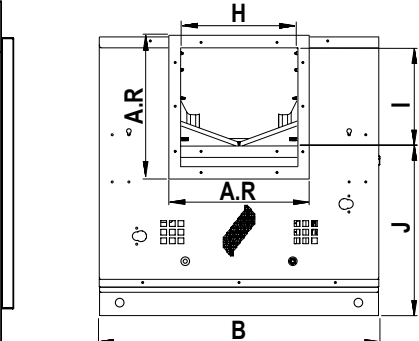

Encombrement (mm) - vue de face

### Electrical datas

References	Id/In	Max. current (A)	Rated current (A)	Voltage (V)	Number of poles	Power (kW)
11039502	6.5-7-6.6(2P)/7(4P)-6.5	2,6- 3,5 - 5,0(2P)/5,1(4P)-6,8	2,3-3,2-4,6-6,2	400	2-2-2/4- 4	1,1 - 1,5 - 2,2 - 3

### Installation visual 1

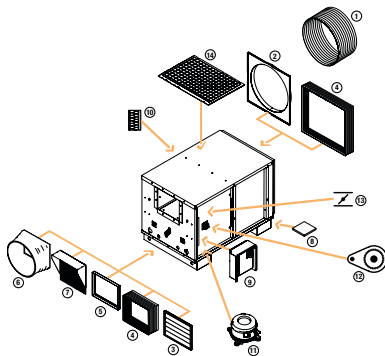

Accessoires ProtectONE T



Schéma en vue de dessus, avec accès gauche



Schéma en vue de dessus, avec accès droit

### Curve

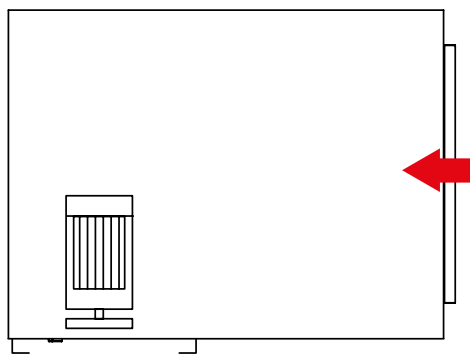

Aeraulic properties ProtectONE® TA 250 - 1SP

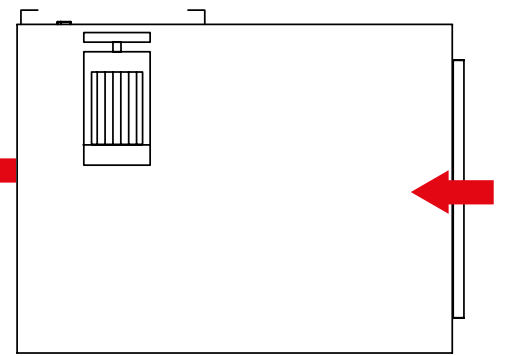
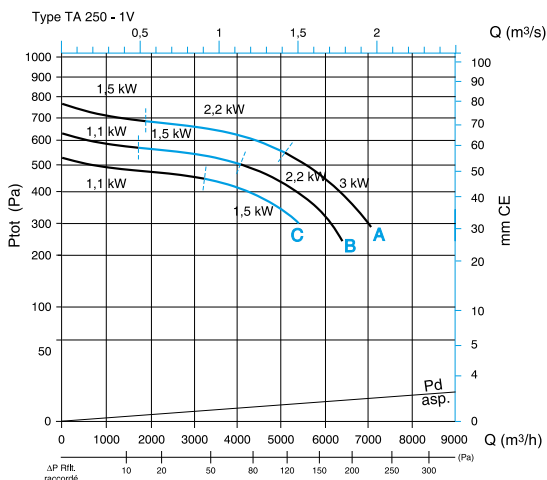
> curves as per NF EN ISO 5801:

- ducted intake, open outlet,
  - Ptot: Total pressure,
  - Pd intake: dynamic pressure in duct on intake,
  - ΔP ducted outlet: higher pressure with ducted outlet rather than open outlet.
- > see ProtectONE TA 225 on use of curves.