

Connector

11094065 RCC REDUCER GALVA - D560/400

The RCC joins two galvanised ducts of different diameters together.



Réduction Conique Concentrique

Product description

The concentric conical reducer connects two galvanised ducts of different diameters together.

Fields of application

Multi-occupancy residential housing, New, Refurbishment, Non-residential buildings

Installation

- easy assembly of interlocking accessories: ducts are female, accessories are male,
- Final seal requires sealant and/or perforated strip,
- attached to duct using self-tapping screws (4 to 6 depending on diameter).

Reference arguments

Application:

- Connects 560 mm circular duct to 400 mm circular duct in a non-residential or multi-occupancy residential system

Description:

- Concentric reducer galvanised steel diameter 560/400 mm

Main characteristics

- available in diameters from 80 to 900,
- galvanised steel as per EN 10346 ensuring uniformity of coating,
- M0 fire certification.

Dimensional data

References	Ø A (mm)	Ø B (mm)
11094065	560	400

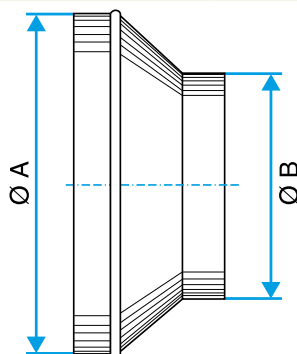

Dimensional drawing Concentric Conical Reducer

Regulatory data

References	Fire protection rating
11094065	M0

Connector

11094065
RCC REDUCER GALVA - D560/400