

## Connector

# 11094071

## RCC REDUCER GALVA - D710/450

The RCC joins two galvanised ducts of different diameters together.



Réduction Conique Concentrique

### Product description

The concentric conical reducer connects two galvanised ducts of different diameters together.

### Fields of application

Multi-occupancy residential housing, New, Refurbishment, Non-residential buildings

### Installation

- easy assembly of interlocking accessories: ducts are female, accessories are male,
- Final seal requires sealant and/or perforated strip,
- attached to duct using self-tapping screws (4 to 6 depending on diameter).

### Reference arguments

Application:

- Connects 710 mm circular duct to 450 mm circular duct in a non-residential or multi-occupancy residential system

Description:

- Concentric reducer galvanised steel diameter 710/450 mm

### Main characteristics

- available in diameters from 80 to 900,
- galvanised steel as per EN 10346 ensuring uniformity of coating,
- M0 fire certification.

### Dimensional data

References	Ø A (mm)	Ø B (mm)
11094071	710	450

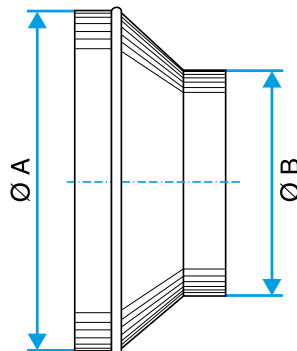

Dimensional drawing Concentric Conical Reducer

### Regulatory data

References	Fire protection rating
11094071	M0

Connector

11094071  
RCC REDUCER GALVA - D710/450