

Connector

11095063

RF ALU D125

The RF aluminium female connector connects two aluminium accessories together.



Raccord Femelle en aluminium

PRODUCT BENEFITS

- range compliant with gas CMEV requirements,
- suited to systems operating in saline atmospheres.

Product description

The RF aluminium female connector connects two aluminium accessories together.

Fields of application

Multi-occupancy residential housing, New, Refurbishment, Non-residential buildings

Installation

- easy assembly of interlocking accessories: ducts are female, accessories are male,
- Final seal requires sealant and/or perforated strip,
- attached to duct using self-tapping screws (4 to 6 depending on diameter).

Reference arguments

Application:

- Connects two accessories of same diameter together in multi-occupancy residential gas CMEV system

Description:

- Aluminium connector diameter 125 mm

Main characteristics

- available in diameters from 125 to 500,
- aluminium 1050A-H18 (formerly A5) compliant with DTU 68.3 for gas CMEV,
- M0 fire certification.

Dimensional data

References	Ø (mm)
11095063	125

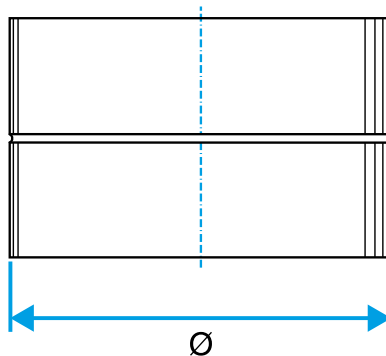

Dimensional drawing Aluminium Female Connector

Regulatory data

References	Fire protection rating
11095063	M0

Connector

11095063
RF ALU D125