

Airflow control

11093067 RF GALVA - D250

The female connector connects two galvanised accessories together.



Product description

The female connector connects two galvanised accessories together.

Fields of application

Multi-occupancy residential housing, New, Refurbishment, Non-residential buildings

Installation

- easy assembly of interlocking accessories: ducts are female, accessories are male,
- Final seal requires sealant and/or perforated strip,
- attached to duct using self-tapping screws (4 to 6 depending on diameter).

Reference arguments

Application:

- Connects two accessories of same diameter together in non-residential and multi-occupancy residential systems

Description:

- Galvanised steel connector diameter 250 mm

Main characteristics

- available in diameters from 80 to 900,
- galvanised steel as per EN 10346 ensuring uniformity of coating,
- M0 fire certification.

General data

Variants	Main material
11093067	Galvanised steel

Dimensional data

Variants	Ø (mm)	Ø A (mm)
11093067	250	250

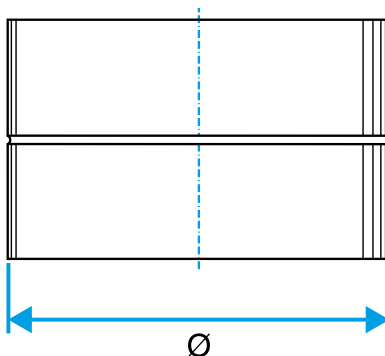

Airflow control

11093067
RF GALVA - D250

Regulatory data

Variants	Fire protection rating
11093067	M0