

**Occasional exhaust fan****11098449**  
**RG GALVA +SEAL - D500**

The RG sealed damper balances a circular ducting system, while ensuring a very low leak rate: class D (up to D315) or C (D355 and beyond).

**PRODUCT BENEFITS**

- class D airtight performance (up to 315 mm) as per EN 1751,

**Principles of operation**

The flap of the sealed RG is opened and closed by rotating a handle located on a jumper.

**Product description**

The RG sealed damper balances airflow in a circular ducting system. It features double-lip airtight seals on each junction to minimise leaks with the rest of the system. Its top jumper enables overlaid insulation without covering the handle.

**Fields of application**

Multi-occupancy residential housing, New, Refurbishment, Non-residential buildings

**Installation**

- installed in circular ducts.

**Reference arguments**

Application:

- Airtight airflow balancing across all branches of a non-residential or multi-occupancy residential ventilation system

Description:

- Sealed damper galvanised steel diameter 500 mm
- Manual control
- Screw-locked plastic handle, M1 class Lexan shafts

**Main characteristics**

- class D airtight performance (315 mm and below) and class C (355 mm and above) as per EN 1751,
- galvanised steel,
- metal handle,
- can be motorised upwards of diameter 355 mm using motor plate kit ordered separately.

**Accessories**

Description	Variants
MOTOR PLATE KIT FOR DIAMETERS 355 to 500 mm	11055122
CM MOTOR 24-L ON/OFF	11055040
TF MOTOR 230 ON/OFF	11055049
TF MOTOR 24 ON/OFF	11055050
CM MOTOR 230-L ON/OFF	11055038

Occasional exhaust fan

**11098449**  
RG GALVA +SEAL - D500

## Dimensional data

Variants	H (mm)	L (mm)	Ø (mm)	Weight (kg)
11098449	80	202	500	3,35

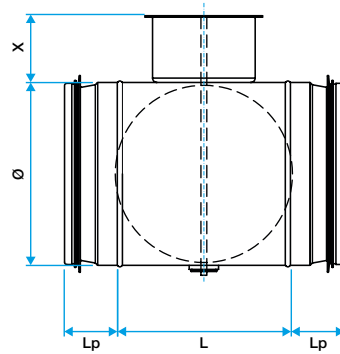

## Regulatory data

Variants	Airtightness class
11098449	C

## Installation

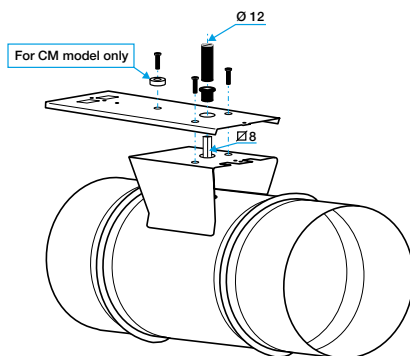

Installation de la platine de motorisation