

## Wipe

11055218  
RGE Ø160 Motorised

The RGE motorised damper uses a motor to balance and isolate a circular ducting system, while ensuring a very low leak rate.



## PRODUCT BENEFITS

- class D airtight performance as per EN 1751,
- easy installation of motor.

## Principles of operation

The flap of the Motorised RGE is opened and closed by a motor installed on the plate.

## Product description

The RGE damper balances airflow and isolates a circular ducting system. It features a sealed disc to minimise air leaks between upstream and downstream of the damper in the closed position and double-lip airtight seals on each junction to minimise leaks with the rest of the system. It can easily be motorised using its plate, which enables overlaid insulation without covering when in the upper position.

## Fields of application

New, Refurbishment, Non-residential buildings

## Installation

- installed in circular ducts.

## Reference arguments

- Damper air tightness provided by jointed disk (overmoulding on disk providing good long-term resistance).
- Double-lip airtight seal on each junction.
- RGE: screw-locked adjustment handle. Zamak shafts.
- Upper jumper provides overlaid insulation without covering handle.
- To motorise RGE dampers beyond 355 mm: order the universal adapter plate (11055122) separately to enable installation of any motor.
- Motor power: 2 N/m for RGE Ø 125 to 200, 4-5 N/m for RGE Ø 250 to 500.
- Beyond Ø 500 mm, for reasons of mechanical resistance, use a CRGE volume control damper with connecting plates of the same Ø as the ducting.

## Main characteristics

- galvanised steel,
- airtight performance upstream/downstream of disc:
  - up to and including diameter 160 mm: class 3 as per EN 1751,
  - diameter 200 mm and above: class 4 as per EN 1751,
- class D product airtight performance as per EN 12237,
- motor plate included,
- motor: 2 N.m for RGE Ø 125 to 200 and 4-5 N.m beyond,
- temperature range: up to +120°C.

## Accessories

Description	Variants
CM MOTOR 24-L ON/OFF	11055040
TF MOTOR 230 ON/OFF	11055049
TF MOTOR 24 ON/OFF	11055050
CM MOTOR 230-L ON/OFF	11055038

Wipe

## 11055218 RGE Ø160 Motorised

### Dimensional data

Variants	H (mm)	L (mm)	Ø (mm)	Weight (kg)
11055218	50	158	160	0,93

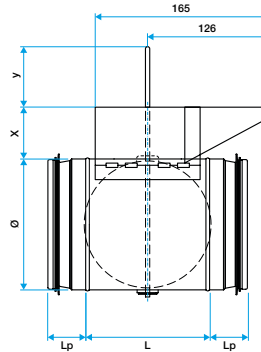

### Regulatory data

Variants	Airtightness class	Upstream/downstream airtightness class
11055218	D	3