

# 11024112

## TAVA® 190 M2

The roof fan range that makes ventilation easier.



Tava

### PRODUCT BENEFITS

- airflow from 500 to 3500 m<sup>3</sup>/h,
- refined design,
- wide range of installation accessories,
- ErP-compliant with speed controller.

### REGLEMENTATIONS AND COMPLIANCES

Technical Opinion no.: 14.5/16-2185\_V2

### Principles of operation

Roof exhaust fan with vertical discharge for CMEV in multi-occupancy housing and non-residential buildings.

### Product description

Aluminium housing for good corrosion resistance, vertical discharge.

### Fields of application

Multi-occupancy residential housing, New, Refurbishment, Non-residential buildings

### Installation

- horizontal outlet,
- flat or sloping roof with masonry base or accessory.

### Reference arguments

Application:

- Roof exhaust fan for flat or sloping roof, vertical jet, 500 m<sup>3</sup>/h
- Designed for multi-occupancy residential or non-residential CMEV

Description:

- Aluminium unit for good corrosion resistance
- Anti-bird screen
- Backward curve centrifuge impeller
- Asynchronous motor single-phase IP33 - 2 poles

### Main characteristics

- 7 sizes available from 500 to 3,500 m<sup>3</sup>/h (for sub-3500 m<sup>3</sup>/h flow rates, see TAVA® Micro-Watt),
- made of weatherproof AlMg3 aluminium with a very low height. The motor unit tilts for easy installation (optional accessories) and maintenance,
- the air outlet features a protective screen against intrusion, birds, and other foreign objects,
- backward curve centrifuge impeller balanced on the motor according to quality class G 6.3 of DIN / ISO 1940,
- the drive motor is designed for maintenance-free operation, thanks to its ball bearings with lifetime lubrication,
- the motor is protected by a thermal switch integrated in the winding,
- single-phase power supply.

### Accessories

Désignations	References
Backdraft damper Ø 180	11024462
Proximity switch 1-speed 1-Ph - 0.9 kW	11056196
Connection flange D180	11024452
Flexible sleeve 180	11024457
Insulated flat roof base with sound attenuator TAHA-TAVA 220	11024446

### General data

References	Type of motor
11024112	AC

## 11024112 TAVA® 190 M2

### Dimensional data

References	A (mm)	B (mm)	C (mm)	D (mm)	E (mm)	F (mm)	G (mm)	Weight (kg)
11024112	190	388	337	95	245	4 x Ø9	Ø213 6xM6	4,5

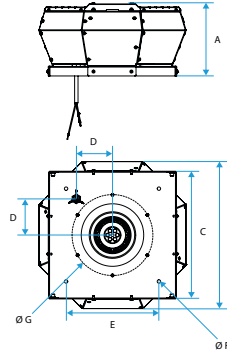

Tava

### Airflow data

References	Airflow (m³/h)
11024112	300

### Electrical datas

References	Protection rating	Max. current consumption SINGLE-PHASE 230 V (A)	Maximum current (A)	Power supply	Number of poles	Max. power
11024112	IP33	0,4	0,4	Single-phase	2	0,067

### Curve

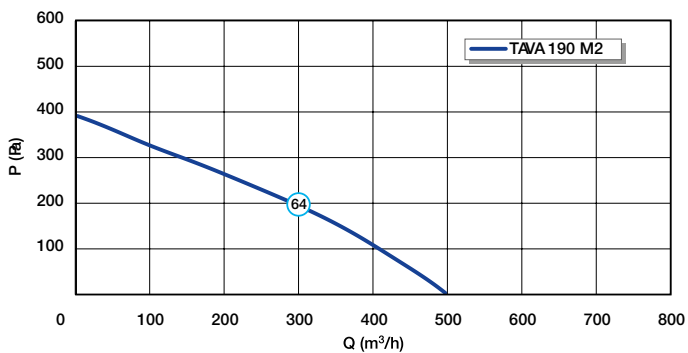

Tava-190